



ModbusRTU

Sample gas cooler RC 3.1

Sample gas coolers are used in extractive gas analysis. The sample gas is taken from the process and may contain impurities such as particles or moisture that can damage the measuring cells or influence the measurement results. For this reason, the moist gas is cooled below the dew point in the sample gas cooler, causing the moisture to condense so it can be removed from the system.

The RC 3.1 is a compressor high performance cooler with a special heat exchanger. Suitable for wall-mounting or desktop operation.

The natural refrigerant R600a meets the requirements of EU Regulation (EU) 2024/573 and is a very environmentally friendly solution thanks to the reduction in CO₂ emissions. At the same time, it ensures the future-proof operation of your systems that comply with legal requirements in the long term.

High-performance cooler with a rated output of 1450 kJ/h

Accurate setting of the gas outlet dew point in a range from +2 °C to +20 °C with a constant dew point stability of ± 0.2 K

Adjustable tolerance ranges (alarm thresholds) for the setpoint temperature of the measuring gas cooler

Special stainless steel heat exchangers, also available with glass coating for corrosive gases

Ambient temperature from +5 °C to +50 °C

Future-proof and climate-friendly: Use of natural refrigerants instead of HFC refrigerants

Option: Signal output 4 - 20 mA for function and temperature monitoring

Option: Digital output (Modbus RTU) for device configuration and access to process and diagnostic data



Overview

The RC 3.1 is a high performance compressor cooler with a special heat exchanger. Suitable for wall-mounting or desktop operation.

This unit is available in various versions. The exact item number of the model defined by you is determined by the model code in the ordering information category.

Application	Cooler model	Heat exchanger
Standard	RC 3.1	1 heat exchanger

Additional components which every conditioning system should feature can optionally be integrated:

- Peristaltic pump for condensate separation,
- Moisture detector.

In addition, we offer a range of signal outputs:

- Status output,
- Analogue output, 4...20 mA, incl. status output,
- Modbus RTU digital output, incl. status output.

This allows for various configurations of the cooler and its options. Here the approach is to simplify the creation of a complete system in a cost-efficient way using pre-installed components with hoses connected. We also prioritised easy access to wear parts and consumables.

Technical Data

Gas Cooler Technical Data		
Rated cooling capacity (at 25 °C):	1450 kJ/h	
Ambient temperature:	5 °C to 50 °C	
Ready for operation:	after max. 15 minutes	
Gas outlet dew point preset:	5 °C	
adjustable:	3 °C to 20 °C	
Dew point fluctuations static:	± 0.2 K	
in the entire specification range:	± 2 K	
IP rating:	IP 20	
Installation:	Table-top or wall mounting	
Housing:	Stainless steel	
Packaging dimensions:	approx. 510 x 450 x 350 mm	
Weight:	approx. 24 kg	
max. altitude:	Altitudes up to 2000 m	
Refrigerant:	R600a	
Electrical connection:	Plug per DIN EN 175301-803	
Contamination level:	2	
Overvoltage category:	II	
Electrical data:		230 V
<i>Available options may result in details that differ from these</i>	Tolerance:	+/-5% at 50 Hz
	Typical power input:	722 VA
	max. operating current:	3.1 A
	Starting current:	5.5 A
	Protection:	6 A
Status output switching capacity:	max. 250 V AC, 150 V DC 2 A, 50 VA, potential-free	
Condensate outlet:	For heat exchanger, see table "Heat exchanger overview" For condensate pump, see "Technical Data - Options"	
Parts in contact with media		
Filter:Moisture detector:	See "Technical Data - Options"	
Heat exchanger:	See table "Heat exchanger overview"	
Peristaltic pump:	see "Technical Data - Options"	
Tubing:	PTFE/FKM (Viton)	

Technical Data - Options

Analogue Output Technical Data

Signal:	4-20 mA or 2-10 V corresponds to -20 °C to +60 °C cooling block temperature
Connection:	M12x1 connector, DIN EN 61076-2-101

Technical Data, digital output

Signal:	Modbus RTU (RS-485)
Connection:	M12x1 connector, DIN EN 61076-2-101

Technical Data Cpsingle Condensate Pumps

Ambient temperature:	0 °C to 60 °C
Flow rate:	0.3 L/h (50 Hz)/0.36 L/h (60 Hz) with standard hose
Inlet vacuum:	max. 0.8 bar
Inlet pressure:	max. 1 bar
Outlet pressure:	1 bar
Weight:	0.47 kg
Hose:	4 x 1.6 mm
Condensate outlet:	Hose nipple Ø5 mm Screw connection 4/6 (metric), 1/6"-1/4" (US)
IP rating:	IP 40
Materials	
Hose:	Tygon (Norpren)
Connections:	PVDF

Technical Data FF-3-N Moisture Detector

Ambient temperature:	3 °C to 50 °C
max. operating pressure with FF-3-N:	2 bar
Weight:	0.04 kg (incl. cable)
Material:	PVDF, PTFE, epoxy resin, stainless steel 1.4571, 1.4576

Heat exchanger description

The energy content of the sample gas and the required cooling capacity of the gas cooler is determined by three parameters: gas temperature ϑ_G , (inlet) dew point τ_e (moisture content) and volume flow v . The outlet dew point rises with increasing energy content of the gas. The approved energy load from the gas is therefore determined by the tolerated rise in the dew point.

The following limits are specified for a normal standard operating point of $\tau_e = 65^\circ\text{C}$ and $\vartheta_G = 90^\circ\text{C}$. The maximum volume flow v_{\max} in NI/h of cooled air is indicated, so after moisture has condensed.

If the values fall below τ_e and ϑ_G , the flow v_{\max} may be increased. For example, on the TG heat exchanger the parameter triple $\tau_e = 65^\circ\text{C}$, $\vartheta_G = 90^\circ\text{C}$ and $v = 280 \text{ NI/h}$ may also be used in place of $\tau_e = 50^\circ\text{C}$, $\vartheta_G = 80^\circ\text{C}$ and $v = 380 \text{ NI/h}$

Please contact our experts for clarification or refer to our design program.

Heat exchanger overview

Heat exchanger	TS10 TS10-I ²⁾	TS10-GB TS10-GB-I ²⁾
Materials in contact with media	Stainless steel	Stainless steel, parts in contact with media are glass-coated
Weight	4.53 kg	4.53 kg
Flow rate v_{\max} ¹⁾	3900 L/h	3900 L/h
Inlet dew point $\tau_{e,\max}$ ¹⁾	80 °C	80 °C
Gas inlet temperature $\vartheta_{G,\max}$ ¹⁾	180 °C	180 °C
Max. cooling capacity Q_{\max}	2150 kJ/h	2150 kJ/h
Gas pressure p_{\max}	5 bar	5 bar
Pressure drop Δp ($v=1500 \text{ l/h}$)	24 mbar	24 mbar
Dead volume V_{dead}	770 ml	770 ml
Gas connections (metric)	G1/4	G1/4
Gas connections (US)	NPT 1/4"	NPT 1/4"
Condensate out connection (metric)	G3/8	G3/8
Condensate out connection (US)	NPT 3/8"	NPT 3/8"

¹⁾ Max. cooling capacity of the cooler must be considered.

²⁾ Models marked I have NPT threads or US tubes, respectively.

Dimensions

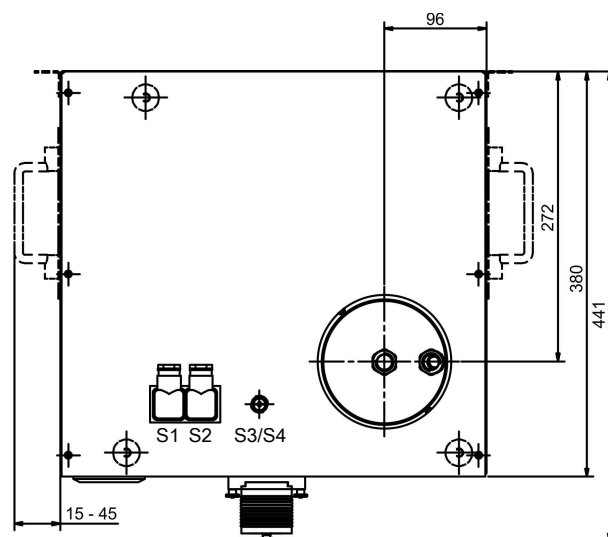
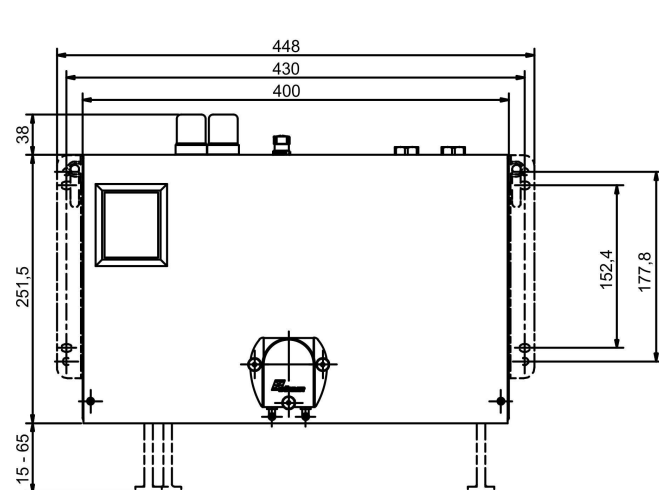

S1 = Electric supply

S2 = Status output

S3/S4 = Analogue/digital output (optional)

Ordering instructions

Gas cooler with one heat exchanger

The item number is a code for the configuration of your unit. Please use the following model key:

4596	7	1	1	0	X	X	X	X	X	0	0	X	X	0	0	0	0	Product characteristic
																		Power supply
																		230 V AC, 50/60 Hz
																		Heat exchanger
																		Stainless steel, TS10 G3/8"
																		Stainless steel, TS10 NPT 3/8"
																		Stainless steel, parts in contact with media are glass-coated, TS10 GB NPT 3/8"
																		Condensate drain
																		without condensate drain
																		CPsingle with hose nipple, angled
																		CPsingle with screw connection, metric/US
																		Moisture detectors
																		without moisture detector
																		with moisture detector
																		Signal outputs
																		status output only
																		Analogue output, 4..20 mA, incl. status output
																		Modbus RTU digital output, incl. status output

Spare Parts and Accessories

Item no.	Description
4410001	Automatic condensate drain 11 LD V 38
4410004	Automatic condensate drain AK 20, PVDF
4410005	Condensate trap GL 1; glass, 0.4 L
4410019	Condensate trap GL 2; glass, 1 L
44921170114	CPsingle 115 V 60 Hz, 1 L/h, metric screw-in connection DN 4/6
44921170115	CPsingle 115 V 60 Hz, 1 L/h, US screw-in connection 1/6"-1/4
44921180114	CPsingle 230 V, 60 Hz, 1 L/h, metric screw-in connection DN 4/6
44921180115	CPsingle 230 V 60 Hz, 1 L/h, US screw-in connection 1/6"-1/4